



19, Gr.Floor,Shanta Industrial Premises Co-op Society Ltd, I.BPatel Road, Goregaon (East) Mumbai - 400063

Tel : 022-26858793 • Cell : 09821271748 • Telefax : 022-26852558

THREE PIECE BALL VALVE (Investment Casting)

Salient Features and Specialities:

- ✦ Positive shut off
- ✦ Longer life
- ✦ Quick in action
- ✦ No lubrication
- ✦ Visual on / off indication
- ✦ Compact design
- ✦ Corrosion resistant
- ✦ Low pressure drop
- ✦ Simplicity
- ✦ Designs available in one piece / two piece / three piece
- ✦ Available in both regular port & full port patterns



Size range : ½" to 6"

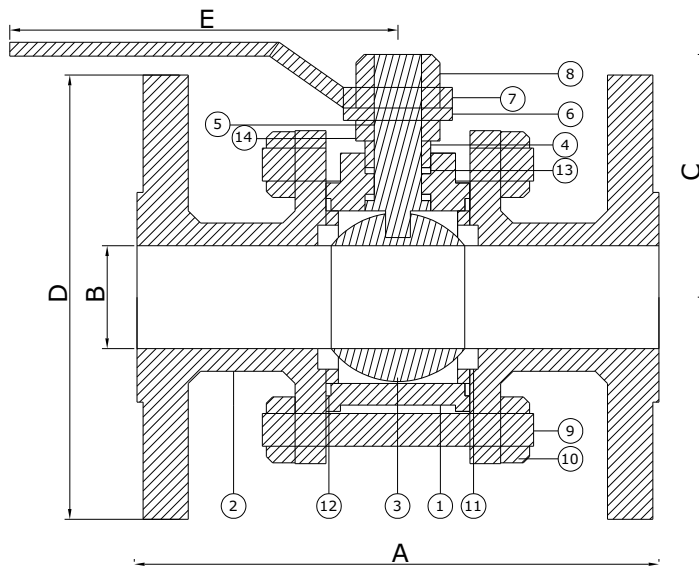

Sr. No.	NAME OF PARTS	MATERIAL
1	BODY	C.F.8 / C.F.8-M / W.C.B
2	ADAPTOR	C.F.8 / C.F.8-M / W.C.B
3	BALL	C.F.8 / C.F.8-M
4	SPINDLE	A.I.S.I 304 / 316 / M.S.
5	STOPPER	S.S. / M.S.
6	HANDLE	S.S. / M.S.
7	NUT	A.I.S.I. 304 / M.S.
8	STUD	A.I.S.I. 304 / M.S.
9	NUT	A.I.S.I. 304 / M.S.
10	SEAL	P.T.F.E.
11	BODY SEAL	P.T.F.E.
12	GLAND SEAL	P.T.F.E.
13	GLANDNUT	A.I.S.I 304 / 304 / M.S.

SIZE	A	B	C	D	E	F
15(N.B.)	108	12	68	89 ½"(A.S.A.-150)	150	11
20(N.B.)	118	19	68	98 ¾"(A.S.A.-150)	150	11
25(N.B.)	127	25	68	108 1"(A.S.A.-150)	175	11
40(N.B.)	165	38	82	127 1½"(A.S.A.-150)	190	14
50(N.B.)	178	50	90	152 2"(A.S.A.-150)	200	16
65(N.B.)	191	63	108	178 2½"(A.S.A.-150)	250	18
80(N.B.)	203	76	132	190 3" (A.S.A.-150)	280	18
100(N.B.)	229	100	155	229 4" (A.S.A.-150)	350	22
150(N.B.)	267	150	225	279 6"A.S.A.-150)	450	25